

IBT series

Square drive hydraulic torque wrench

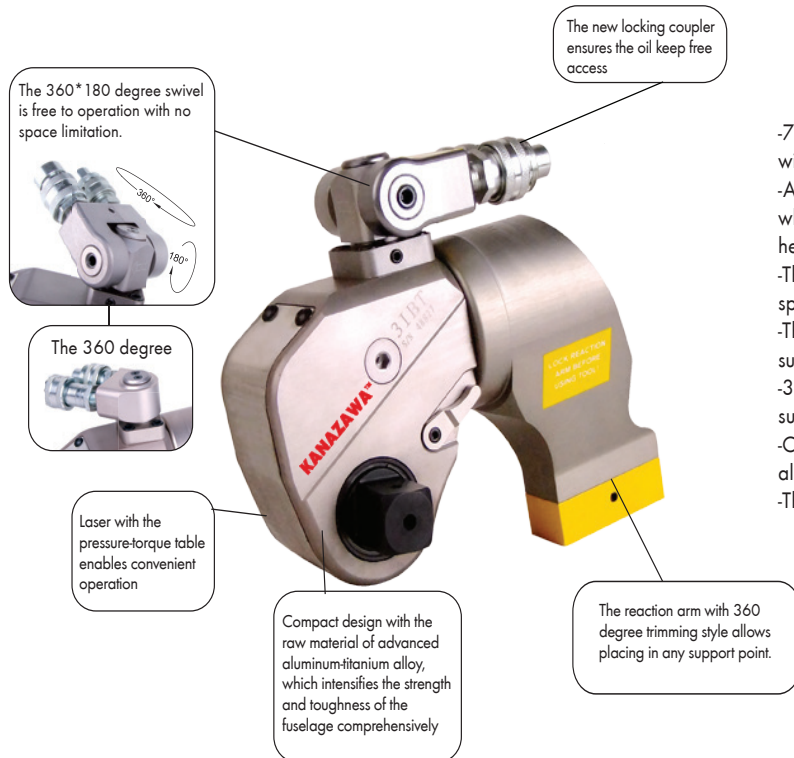

- 70Mpa Max working pressure and the accuracy keep within $\pm 3\%$
- All models with the range from 112N.m to 72000N.m, which covers the most bolts size, and be the most comprehensive available in the market.
- The 360° 180 degree swivel is free to operation with no space limitation.
- The square drive operate with the high intense socket and suitable with large range of bolts
- 360 degree adjustable reaction arm allows placing in any support point.
- Compact design with the raw material of advanced aluminum-titanium alloy, high intense.
- The new locking coupler ensures the oil keep free access.

IBT series is the professional hydraulic torque wrench which KANAZAWA vigorously extends in international market. Its raw material is aluminum-titanium alloy which makes the wrench light and high intense. IBT series has Various models with the range from 112N.m to 72000N.m; covers the most of bolts size, and be the most comprehensive available in the market. KANAZAWA provide after-sales service all over the world, and already got the approved by TUV certificate.

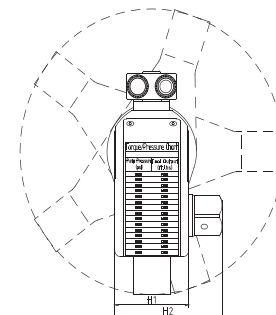
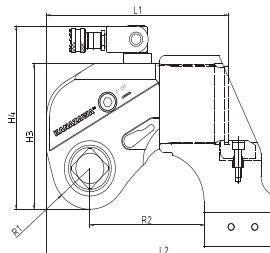

IBT Series Selection Chart

Stock Code	AQ04647	AQ04648	AQ04649	AQ04650	AQ04651
Type	1 - IBT	3 - IBT	5 - IBT	10 - IBT	25 - IBT
Torque (N.m)	183~1837	451~4512	752~7528	1551~15516	3472~34725
Bolt Size (M)	16~36	22~48	27~56	36~72	48~100
Weight Kg	2.5	5	8	15	35
L1	144.5	178	210.5	245.5	323
L2	173.5	229	270.5	317.5	401
H1	50	68	80	100	137
H2	72	95	123	142	200
H3	96	127	149	182	247
H4	131	176.5	199	232	297
R1	26	34	39	51	66
R2	85	114	137	154	199
Square Drive	3/4"	1"	1-1/2"	1-1/2"	2-1/2"

KANAZAWA

ALLINTON ENGINEERING & TRADING PTE LTD

331 Jalan Besar Singapore 208983

T65 6296 0679 W allinton.com.sg E sales@allinton.com.sg